

VG Application Thornton Dale

From: **Clare James** (clare.p.james@hotmail.co.uk)
Sent: 02 April 2011 15:22:27
To: chris.stanford@northyorks.gov.uk

Dear Mr Stanford,

Just a note to say thank you for your help and cooperation when we spoke about this application on the phone last Friday .

For the avoidance of doubt, I understand we have agreed the following;

that NYCC is happy to receive an application from us to cover Section 15(2) & Section 15(3) of the Commons Act 2006 at the same time, captured in one application, but dealing with two different landowners. The reason behind this is because we are concerned, in essence with one composite piece of claimed land, except that a portion of it was recently sold to a Housing Association who have started building work. Based on your advice, we will include three separate large scale maps with the application form 44. One will show the whole area of claimed land. The second will show the portion owned by the Housing Association. The third will show the portion owned by the current landowner (who was also the owner of that portion which has now been sold for development)

In view of these circumstances, it is difficult to expect every witness to appreciate the nuances of what you and I have agreed. I have therefore taken the liberty of 'pre-ordaining' the answers to a few of the questions on the witness form. Eg. Have you ever been prevented from using the land? - I have provided - No; except for the Sanctuary housing proportion which was enclosed on 15/2/11.

I have taken this approach for the sake of clarity. Each witness has been given the opportunity to strike out anything they wish and insert their own words. I hope, when the application reaches your department you do not perceive this as an attempt to influence the witnesses.

On balance i thought that clarity was more important than the risk of receiving witness statements which showed confusion. None of the 'pre-ordained' questions have any connection to their contributions on actual use of the land.

I hope this is a true reflection of what we have agreed and that my handling of the witness forms is acceptable considering the unusual circumstances of this application. I will assume you are OK with this unless I hear to the contrary.

Kind Regards
Tony James
(Spokesman for the Westgate Protest Group)

Jane.1 Wilkinson

From: Mary Davies
Sent: 09 January 2012 17:36
To: Jane.1 Wilkinson
Subject: FW: Ryedale Area Committee

Hi Jane,

Please see email below from Sue Cowan - re: Aunumns Field Thornton-le-Dale.

Thanks.

Mary

Mary Davies
Senior Democratic Services Officer/Appeal Clerk Room 8 County Hall Northallerton
DL7 8AD
01609 532840
mary.davies@northyorks.gov.uk

-----Original Message-----

From: Judith Nesbitt
Sent: 09 January 2012 17:05
To: Mary Davies
Cc: David Bowe
Subject: FW: Ryedale Area Committee

FYI

-----Original Message-----

From: Sue Cowan [mailto:sue.cowan123@tiscali.co.uk]
Sent: 09 January 2012 16:38
To: Judith Nesbitt
Subject: RE: Ryedale Area Committee

Hello

Thanks for the information re the Area Committee meeting on Weds 11 th January and item 7 the application to register a new village green at aunumns field Thornton-le-Dale I see from that the sub planning meeting is on Friday 13 th January unfortunately I cannot attend either but would like to register my objection to the application.

I lived in Thornton-le-Dale for 60 years as a child attending the old school there. I have to tell you that in all that time this site was never used as a play area or anything else to do with recreation. I am fully aware of the desperate need for affordable housing for young families and fully support the development there. It would be absolutely farcical if this application is used to destroy one of the final opportunities to achieve affordable housing for the village.

In TLD as you are no doubt aware there is a lovely playing field, football and cricket fields everything you could possibly need. There is also a really picturesque village green which is used for band concerts, conkering, christmas lights displays amongst many. Please do not be misled by this application. While the persons that have put in this application will say, as they have previously, that as I no longer live in TLD my views shouldn't be counted. I moved to Pickering 4 years ago to be nearer to my family. but lived in thornton -Le _Dale for 60 years as a child and an adult.

My husband was born there and is of the same mind as me that we cannot ever recall that field being used in any way as is suggested in the application.

Would you provide a copy of this objection to David Bowe Corporate director Many thanks Yours Sue Cowan
4 Grebe Way
Pickering
YO18 8TL

-----Original Message-----

From: Judith Nesbitt [mailto:Judith.Nesbitt@northyorks.gov.uk]
Sent: 09 January 2012 14:48
To: 'sue.cowan123@tiscali.co.uk'
Subject: Ryedale Area Committee

Hi

Attached as requested, item 7 for Ryedale Area Committee.

Regards
Judith

Mrs Judith Nesbitt
Democratic Services
County Hall
Northallerton
North Yorkshire
DL7 8AD
Tel: 01609 532212

Access your county council services online 24 hours a day, 7 days a week at www.northyorks.gov.uk.

WARNING

Any opinions or statements expressed in this e-mail are those of the individual and not necessarily those of North Yorkshire County Council.

This e-mail and any files transmitted with it are confidential and solely for the use of the intended recipient. If you receive this in error, please do not disclose any information to anyone, notify the sender at the above address and then destroy all copies.

North Yorkshire County Council's computer systems and communications may be monitored to ensure effective operation of the system and for other lawful purposes. All GCSX traffic may be subject to recording and/or monitoring in accordance with relevant legislation.

Although we have endeavoured to ensure that this e-mail and any attachments are free from any virus we would advise you to take any necessary steps to ensure that they are actually virus free.

If you receive an automatic response stating that the recipient is away from the office and you wish to request information under either the Freedom of Information Act, the Data Protection Act or the Environmental Information Regulations please forward your request by e-mail to the Data Management Team (datamanagement.officer@northyorks.gov.uk) who will process your request.

North Yorkshire County Council.
No virus found in this incoming message.
Checked by AVG - www.avg.com

Version: 9.0.925 / Virus Database: 271.1.1/4130 - Release Date: 01/08/12

Westholme, Main Street, Sinnington
York, YO62 6SQ
Tel: 01751 432397 Email: liz@firefly-research.co.uk

20th November 2011

Chair of the Planning & Regulatory Functions Sub-Committee
North Yorkshire County Council,
County Hall,
Northallerton
DL7 8AD

Dear Chairman and Members

Re: Creation order to record a public bridleway on the definitive map and statement at Lingy Plantation, Ebberston, Ryedale

I am writing on behalf of Ryedale Bridleways Group to urge you to support the creation order to record a public bridleway on the definitive map and statement at Lingy Plantation, Ebberston, and to give authority for the Council to submit the order to the Secretary of State for a decision on whether or not the order should be confirmed.

Ryedale Bridleways Group represents a wide cross section of horse riders who regularly use the bridleways network in Ryedale. Our aim is to work with the County Council, NYMNP and other bridleways users such as the Ramblers and the Cycle Touring Club, to maintain and improve the network. From the outset we have supported this creation order, and over the last three years, have voiced our support at the Council's Rights of Way Liaison group meetings.

The proposed route joins an existing unclassified, un-surfaced road (UUR) which in turn links to a bridleway. Without this route it is not possible to access the eastern end of the UUR without making a 5km detour to the south. This route has been used harmoniously by walkers, horse riders and cyclists for many years and forms part of the well established Moors to Sea Cycle Route. There is therefore clearly a need for it to be recorded on the definitive map. As you will know, a creation order such as this, made under the Highways Act 1980 is primarily about 'need' and quite different to a

definitive map modification order made under the Wildlife and Countryside Act 1981 which relies on historic evidence and /or 20 year user evidence.

We are very disappointed that the British Horse Society has objected to the order. This objection was made without consulting local users and the Society has continued to object in the knowledge that their stance is not supported by local users. The British Horse Society could lift their objection at any time and despite a number of requests from our group, refuses to do so. We understand that the BHS's objection is based on their view that the route should be open to horse drawn vehicles. However, in the past the route has been misused and badly damaged by motor vehicles and we are very concerned that by making the route accessible to horse drawn vehicles it will once again open it up to damage by motor vehicles. When the order was advertised, to our knowledge no representation was made by any person wanting to use the route with a horse drawn vehicle and indeed the route has been blocked on and off for many years to horse drawn vehicles.

We therefore strongly support the Council in their making of the order for a bridleway.

Yours sincerely,

E.V. Newbronner.

Liz Newbronner
Chair of Ryedale Bridleways Group

Creation of Public Bridleway - Givendale Head to Lingy Plantation

Supporting Statement of Karl Gerhardsen, Head of Recreation and Access North York Moors National Park Authority (NPA)

The location of this route is of great importance for people traversing the southern edge of the National Park due to its location in the landscape. It lies on the crest of the Tabular Hills. So called because of their distinctive table-top shape, they rise up gently from the south ending abruptly in a series of steep north-facing headlands or nabs. Ranging from 150m to over 300m, the nabs have developed as springs have eroded the face of the scarp away and offer a striking contrast to the sloping moors beyond. The rocks of the Tabular Hills are known as the Middle Oolite Group as they are made up of ooliths which are tiny grains of sand or pieces of shell, surrounded by layer upon layer of lime to make limestone. This is naturally free draining, so makes for sustainable ground for horse-riding, walking and cycling throughout the year.

The short stretch of bridleway to be created completes a missing link in a superb access route for bridleway users extending to 11 km of hill crest route between the valley of Dalby beck to the west and Forge Valley to the east. Once the valley sides are climbed, the route along the top is almost flat, making for easy and convenient progress. The only other direct east-west route is the busy A170 lying near the foot of the Tabular Hills some 4km away to the south but this is too busy to be a recreational route to be used for pleasure by non-motorised users. There are other routes to the north, but these are off the tabular hills so are often wet and require significantly more effort due to hilly terrain and challenging navigation. The hill-crest route by contrast is dry and easy to follow with a natural flowing line along the hill top with extensive views to both north and south to be seen where there are gaps in the trees.

The National Park Authority already promotes this route as part of its Regional Route Network. These are multi-day routes, waymarked on the ground for people to enjoy under their own steam using local facilities to put something back into the local economy. The 48 mile long Tabular Hills Walk from Helmsley to Scarborough comes this way as does the Moor to Sea Cycle-route from Pickering to Scarborough and Whitby. Further details of both routes are attached.

In the late 1990s I recall receiving regular complaints from local horse-riders (including Joan Lasham of Clock Cottage, Main Street, Irton) frustrated by a large wet hole which had appeared in the route. They found this difficult or even impossible to ride, either through or round and were therefore unable to complete their chosen rides. This demonstrates the local demand for the route as a public bridleway and the value of it as a vital link facilitating circular local riding routes. The omission of this section from the Definitive Map of Public Rights of Way, made resolution of the problem more complex, but the NPA was able to use its sustainable tourism budget and, with the agreement of respective frontagers, was able to repair the hole and the track itself to its present condition. This now appears to sustain the current level of recreational use and agricultural access without the need for any further work.

To conclude, I believe this bridleway creation to be necessary to meet demand from both local people and visitors to the National Park. It is a strategically important link in the local network for horse-riders, pedal cyclists and walkers and can I hope be created without further delay.

Karl Gerhardsen Head of Recreation and Access 4 October 2011



NORTH ENTRANCE
FROM CROFTON
LANE



THIS IS NOT A
PUBLIC FOOTPATH
PRIVATE ACCESS
ONLY



PART WAY
DOWN.

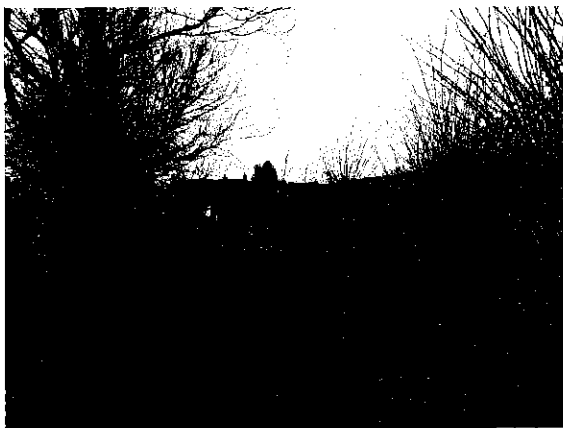

$\frac{2}{3}$ DOWN
NEW GATE &
POSTS ACROSS
sept/oct
2011



BOTTOM END TO GARDEN GATE
& INTO HOLLY CLOSE



"CCTV IN OPERATION"
FROM HOLLY CLOSE

7.1.12



7581

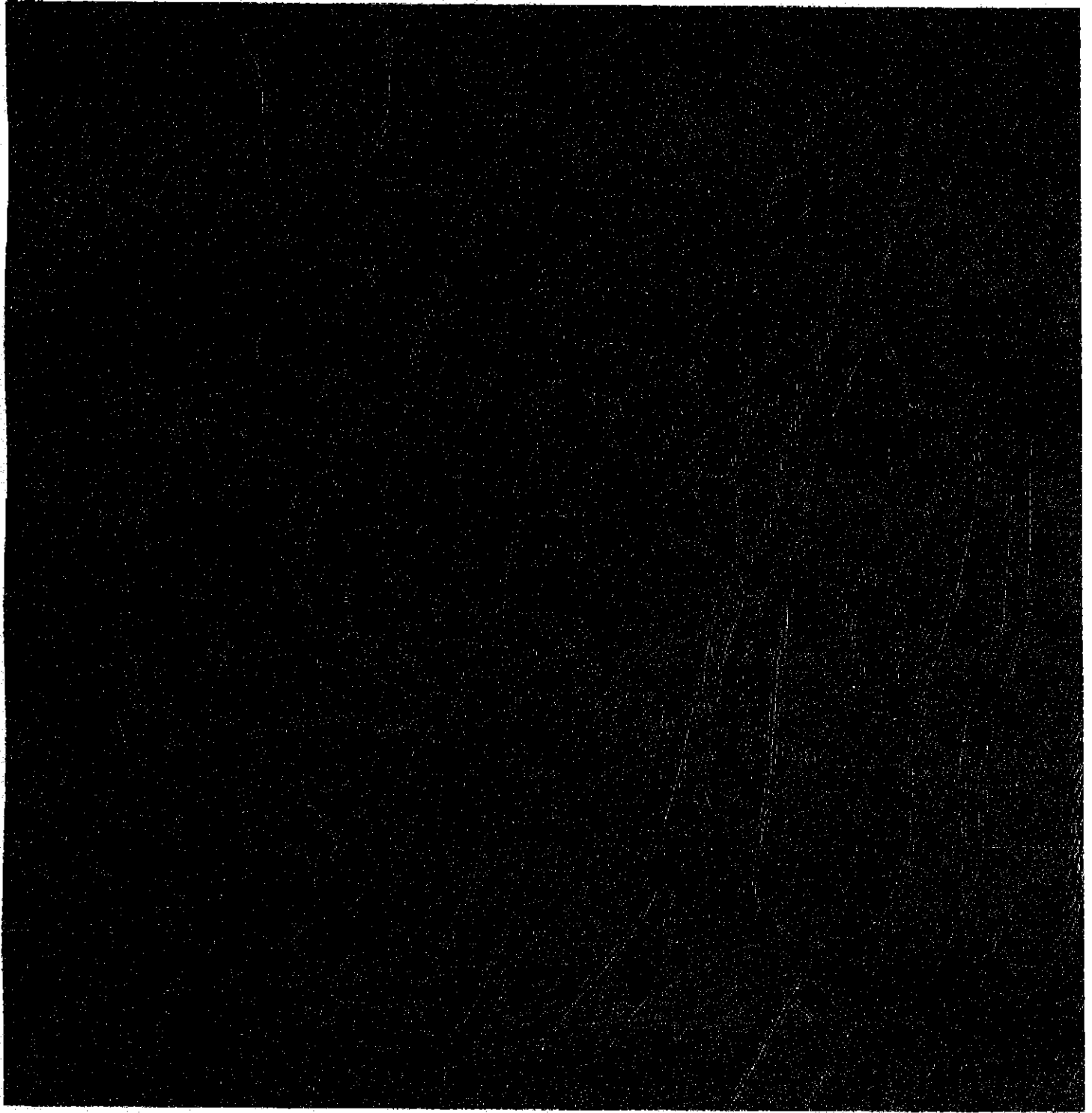

WRELTON circa 1880

2005

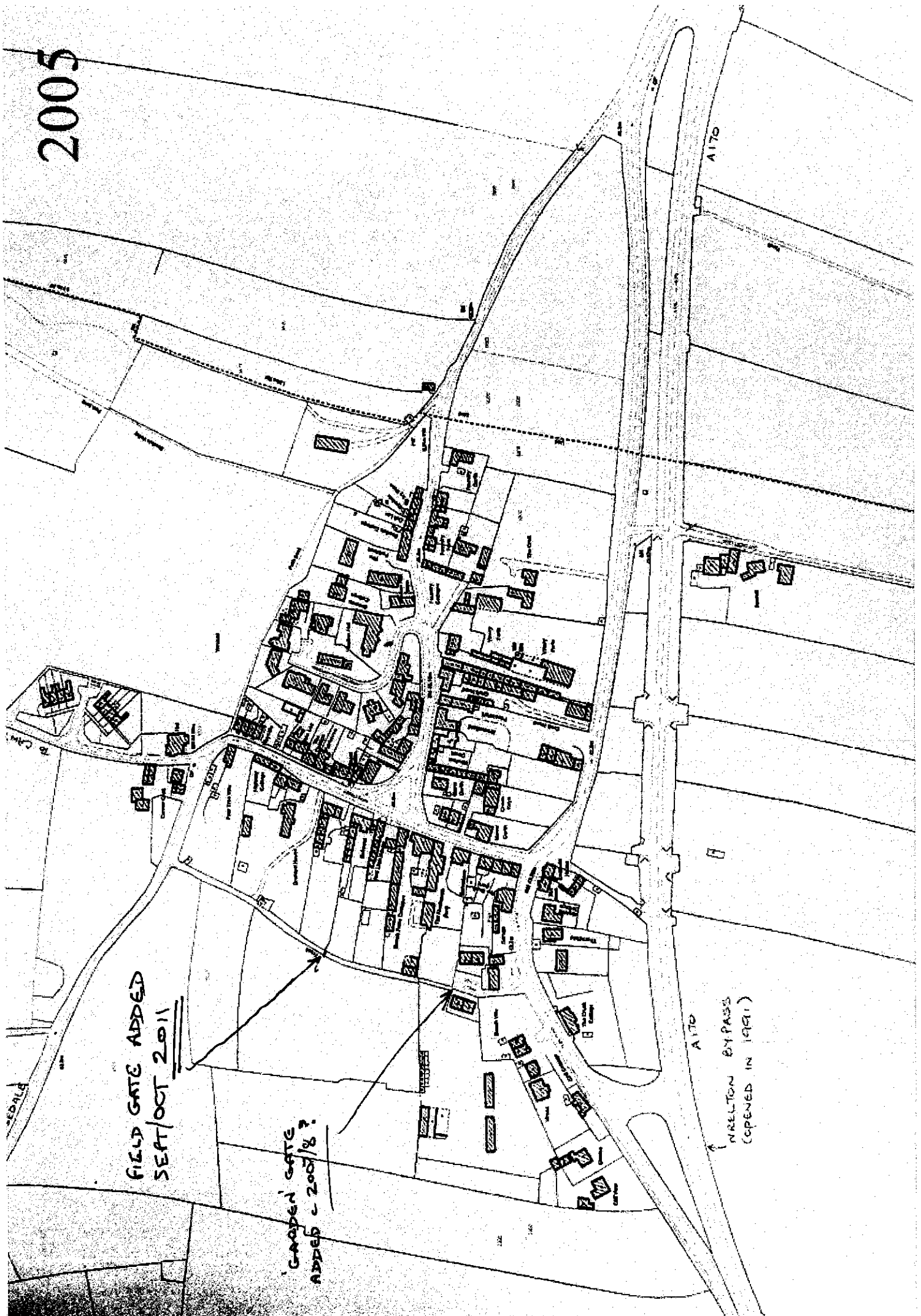

FIELD GATE ADDED
SEPT/OCT 2011

'GARDEN' GATE
ADDED - 2007/8?

A170
NRELTON BYPASS
(OPENED IN 1991)

WRELTON BACK LANE IN THE 1960's

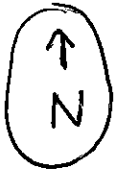

CROFTON LANE

E WILSON/DALE

COULTMANS/WARD
FIELD

SW DENNIS/J WILSON

BACK LANE ENTRANCE NOT USED
UNTIL EARLY 70's BY J WILSON

COULTMANS/WARD
FIELD

BACK LANE

B BLOKHORN



COULTMAN/WARD
BUSCH FARM

STYLE
(REMOVED IN
MID 60's)

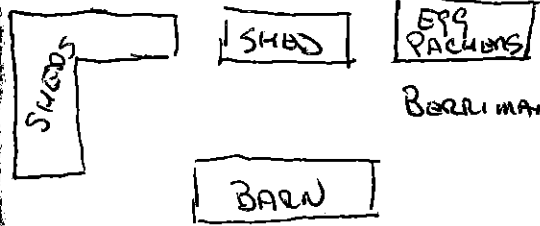

BERRIMAN/HUNTSMAN

MISS ?

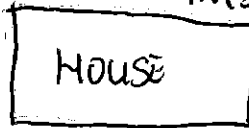

← HIGH WALL



J SCOTT

WATER TAP

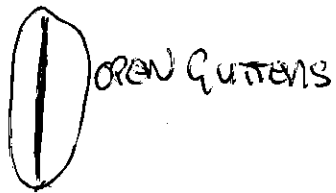
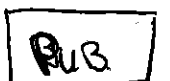
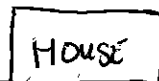

DRY STONE WALLS

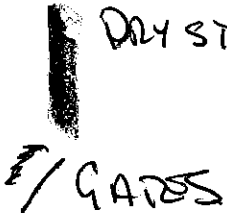

CLIFF ROAD

TRANSCRIPT

BACK LANE - WRELTON

Anglo Saxon villages like Wrelton were usually built around a Main Street with one or maybe two **back lanes** running parallel to ~~provide a~~ ^{form a} rectangular layout of the village. The Back Lanes allowed **for animal's to be driven around (not through) the village** and importantly **provided access to the Burgage plots which were owned and cultivated by all villagers**. The back lane was effectively common land owned and shared by all the villagers to allow public access to the plots.

During the Land Enclosures of 14 /15 /16th centuries hedges, fences and walls were erected around areas of "owned" land and the Back Lanes retained their usage and status for public access. ^{THEY} ~~and~~ have been used by all manner of residents and passers-by ever since.

Local maps dated around 1854, 1880 & 1928 clearly show our Back Lane and confirm it to be part of the rectangular layout of Anglo Saxon times, and therefore a long established feature.

You will already know of more recent users of our Back Lane from the letters and statements submitted to you, maybe including some from those who regularly used the Lane to go to the Village School before it became the Village Hall.

In 2002/3 the NYCC were unable to establish ownership of the Back Lane when they needed to install a flood prevention drain. They wrote to inform (but not seek approval from) residents of all adjoining properties about the work to be carried out.

It is only in the past 3-4 years that attempts have been made to privatise Back Lane with a small garden gate at the southern end and very recently a full size field gate half way along (erected in Sept / Oct 2011).

All of this has caused a great deal of upset and anger in the community and I substantiate this statement by explaining that I have published and delivered the village newsletter to every house every month since 1994 and so know how the community feels.

Should we allow centuries of our community history to be overturned in this way?...OR should we follow the precedents of the Back Lane in Appleton le Moors which has public access, and the two in Middleton which are now narrow tarmac roads maintained by NYCC Highways.

I ask you to confirm the historical importance of Back Lane and recognise the wishes of the majority of current residents to designate it as a Public Footpath, thereby ensuring continuation of centuries of public access and public ownership.

Thank you for allowing me this opportunity to address the committee.

Peter J Anderson
Manor Garth, Wrelton

COPPICE FARM

WRELTON

PICKERING

TO whom it may concern

I walked the back lane from the late 1950's to go to SCOTT'S GARAGE for radios batteries ECT, also as a family on Sunday evenings calling at BUCK INN for crisps + Pop in 1960-70 I walked it Road a horse + bike up and down the lane, then it was used as a short cut to Pudd, lately is used for walking children + grandchildren + dog as I come up to retiring I've never had to get Permission or had any objections, some signs appeared in last two years but I ignored them as I've walked it regularly for 55 years and consider it a PUBLIC RIGHT OF WAY

Yours

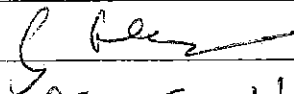

GEORGE W HARRISON

My GRANDFATHER AND FATHER LIVED AT
COPPICE FARM FROM 1927 and ~~did not~~ use
the back lane I have been told

J Harrison